

# AUBURN BALL BEARING SC-100

## BALL THRUST BEARING TOTALLY ENCLOSED SELF CONTAINED "AUBURN" GROOVES

Auburn Enclosed Style SC-100 Ball Thrust Bearing answers the need for an easily installed bearing requiring a minimum of machine work for its use. It is self-contained totally enclosed unit and is recommended for use in exposed locations where a protection from foreign matter is required.

## MOUNTING INSTRUCTIONS:

Enclosed Style SC-100 Ball Thrust Bearing is generally installed so that the race with the sleeve attached to it seats against a fixed part of the machine and is stationary.

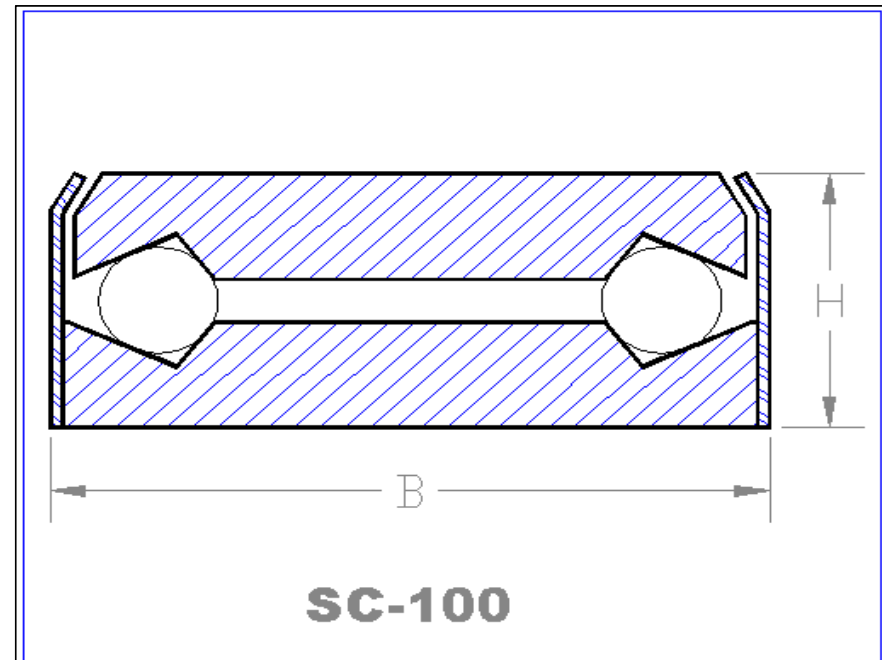

# AUBURN BALL BEARING SC-100

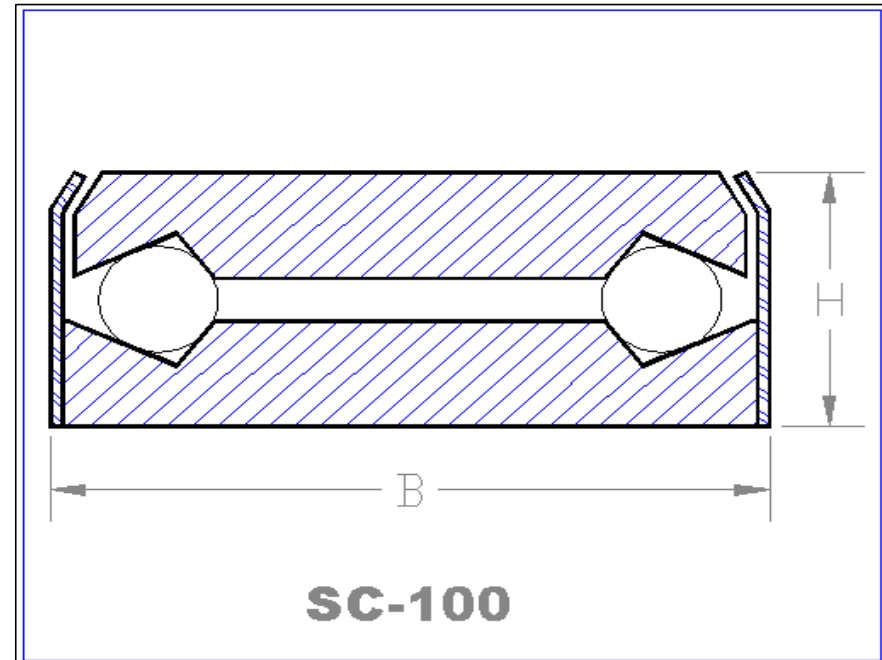

# AUBURN BALL BEARING SC-100

Bearing Number	DIMENSIONS IN INCHES					THRUST LOAD CAPACITY IN LBS. AT VARIOUS SPEEDS								
	B Outside Diameter	B Tolerance +.000	H Height	H Tolerance + or -	Balls No. - Size	Bearing Weight in Lbs.	25 RPM	50 RPM	100 RPM	200 RPM	300 RPM	500 RPM	1000 RPM	1500 RPM
SC-00	11/16	-.002	5/16	.005	12 - 1/8	.06	600	485	395	320	285	245	200	175
SC-0	3/4	-.002	5/16	.005	13 - 1/8	.08	630	515	415	340	300	260	210	185
SC-3/8	1 3/16	-.003	1/2	.005	12 - 7/32	.16	1730	1405	1140	925	820	700	570	505
SC-1/2	1 3/16	-.003	3/8	.005	17 - 5/32	.12	1155	935	760	615	545	470	380	335
SC-1	1 3/16	-.003	5/8	.005	10 - 1/4	.26	1930	1570	1275	1035	915	785	635	565
SC-2	1 3/8	-.003	5/8	.005	12 - 1/4	.28	2225	1805	1465	1190	1050	905	735	645
SC-3	1 1/2	-.004	11/16	.005	14 - 1/4	.33	2480	2015	1635	1325	1175	1005	820	725
SC-4	1 13/16	-.005	11/16	.005	13 - 5/16	.58	3570	2895	2350	1905	1690	1450	1175	1040
SC-5	2	-.005	13/16	.005	12 - 3/8	.73	4700	3815	3095	2510	2225	1905	1550	1370

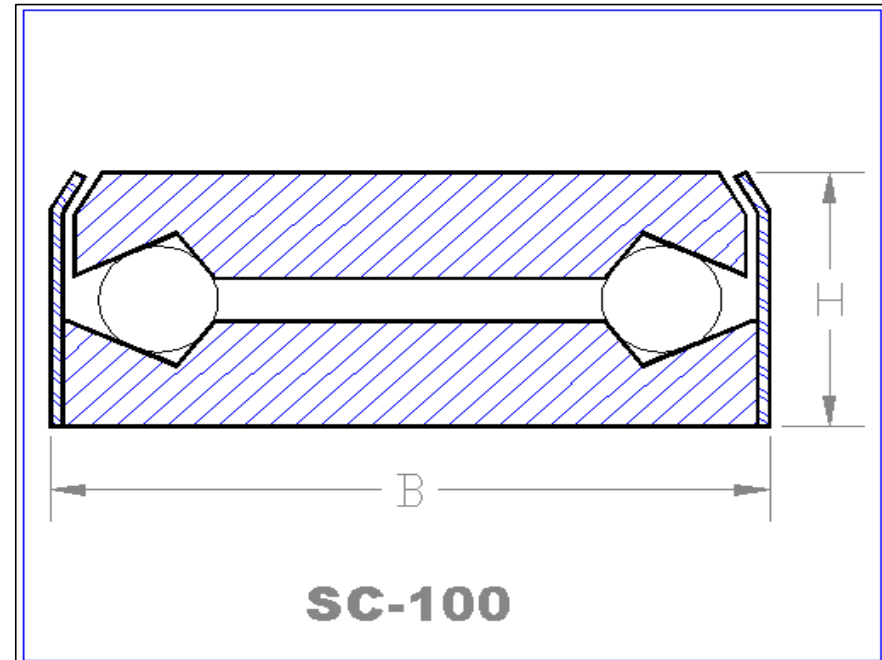

# AUBURN BALL BEARING SC-100

DIMENSIONS IN INCHES

THRUST LOAD CAPACITY IN LBS. AT VARIOUS SPEEDS

Bearing Number	B Outside Diameter	B Tolerance +.000	H Height	H Tolerance + or -	Balls No. - Size	Bearing Weight in Lbs.	THRUST LOAD CAPACITY IN LBS. AT VARIOUS SPEEDS							
							25 RPM	50 RPM	100 RPM	200 RPM	300 RPM	500 RPM	1000 RPM	1500 RPM
SC-6	2	-.005	11/16	.005	15 - 5/16	.60	3940	3195	2595	2105	1865	1600	1300	1150
SC-10	2 3/16	-.006	13/16	.005	13 - 3/8	.85	4985	4045	3285	2665	2360	2025	1645	1455
SC-11	2 3/16	-.006	15/16	.005	13 - 3/8	.95	4985	4045	3285	2665	2360	2025	1645	1455
SC-12	2 3/16	-.006	11/16	.005	16 - 5/16	.66	4100	3325	2700	2190	1940	1665	1350	1195
SC-13	2 3/16	-.006	11/16	.005	17 - 5/16	.68	4250	3450	2800	2275	2010	1725	1400	1240
SC-14	2 13/32	-.006	15/16	.005	15 - 3/8	1.11	5505	4465	3625	2940	2605	2235	1815	1605
SC-17	2 13/32	-.006	11/16	.005	18 - 5/16	.76	4395	3565	2895	2350	2080	1785	1450	1280
SC-18	2 13/32	-.006	11/16	.005	19 - 5/16	.78	4525	3665	2975	2415	2135	1835	1485	1315
SC-19	2 1/2	-.006	15/16	.005	16 - 3/8	1.27	5730	4650	3775	3065	2710	2325	1890	1670

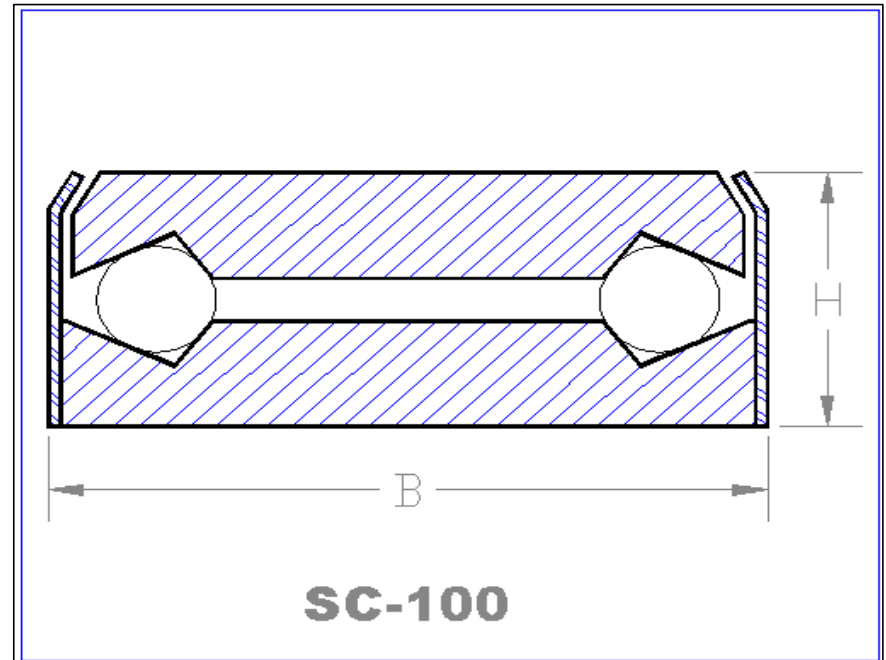

# AUBURN BALL BEARING SC-100

DIMENSIONS IN INCHES

THRUST LOAD CAPACITY IN LBS. AT VARIOUS SPEEDS

Bearing Number	B Outside Diameter	B Tolerance +.000	H Height	H Tolerance + or -	Balls No. - Size	Bearing Weight in Lbs.	THRUST LOAD CAPACITY IN LBS. AT VARIOUS SPEEDS							
							25 RPM	50 RPM	100 RPM	200 RPM	300 RPM	500 RPM	1000 RPM	1500 RPM
SC-20	2 19/32	-.007	15/16	.005	17 - 3/8	1.35	5945	4825	3915	3180	2815	2410	1960	1735
SC-21	2 19/32	-.007	11/16	.005	20 - 5/16	.67	4630	3750	3050	2475	2190	1875	1525	1350
SC-24	2 19/32	-.007	11/16	.005	21 - 5/16	.69	4750	3855	3130	2540	2250	1930	1565	1385
SC-25	2 3/4	-.007	11/16	.005	22 - 5/16	.99	4820	3910	3175	2575	2280	1955	1590	1405
SC-26	2 3/4	-.007	13/16	.005	18 - 3/8	1.33	6140	4985	4045	3285	2905	2490	2025	1790
SC-27	2 3/4	-.007	13/16	.005	23 - 5/16	1.21	4910	3985	3235	2625	2325	1995	1620	1430
SC-28	2 3/4	-.007	1	.005	15 - 7/16	1.51	7280	5910	4795	3890	3365	2955	2400	2120
SC-29	3	-.008	1 3/16	.005	14 - 1/2	3.34	8830	7165	5815	4720	4180	3580	2910	2575
SC-30	3	-.008	13/16	.005	20 - 3/8	1.42	6485	5260	4270	3465	3070	2630	2135	1890

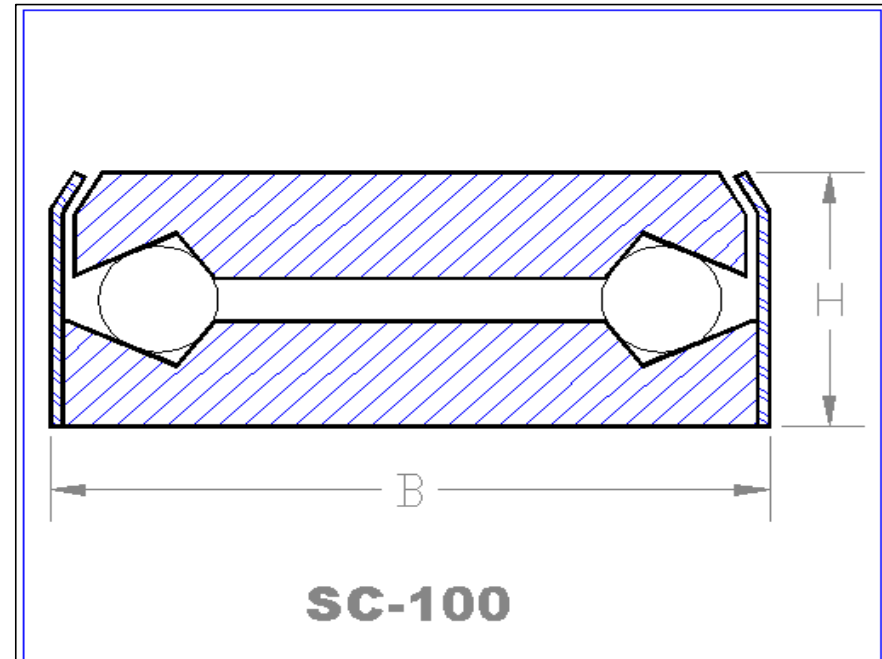

# AUBURN BALL BEARING SC-100

Bearing Number	DIMENSIONS IN INCHES					THRUST LOAD CAPACITY IN LBS. AT VARIOUS SPEEDS								
	B Outside Diameter	B Tolerance +.000	H Height	H Tolerance + or -	Balls No. - Size	Bearing Weight in Lbs.	25 RPM	50 RPM	100 RPM	200 RPM	300 RPM	500 RPM	1000 RPM	1500 RPM
SC-32	3 3/16	-.008	1 1/8	.005	15 - 1/2	2.15	9255	7510	6095	4945	4380	3755	3050	2825
SC-33	3 3/16	-.008	13/16	.005	26 - 5/16	1.70	5070	4115	3340	2710	2400	2060	1670	1480
SC-35	3 1/4	-.008	13/16	.005	22 - 3/8	2.33	6755	5485	4450	3610	3195	2740	2225	1970
SC-36	3 1/4	-.008	13/16	.005	28 - 5/16	2.20	5130	4165	3380	2745	2430	2085	1690	1495
SC-37	3 1/4	-.008	1 3/16	.005	16 - 1/2	2.58	9640	7825	6350	5155	4560	3910	3175	2810
SC-39	3 7/8	-.010	1 1/4	.005	19 - 1/2	3.67	10635	8630	7005	5685	5030	4315	3505	3100
SC-41	4	-.010	1 1/4	.005	20 - 1/2	3.79	10900	8845	7180	5830	5160	4425	3590	3175
SC-41A	4	-.010	1 5/8	.005	13 - 11/16	5.00	14690	11920	9675	7855	6950	5960	4840	4280
SC-43	4 5/8	-.010	1 1/2	.005	19 - 5/8	5.95	15780	12805	10395	8435	7470	6405	5200	4600

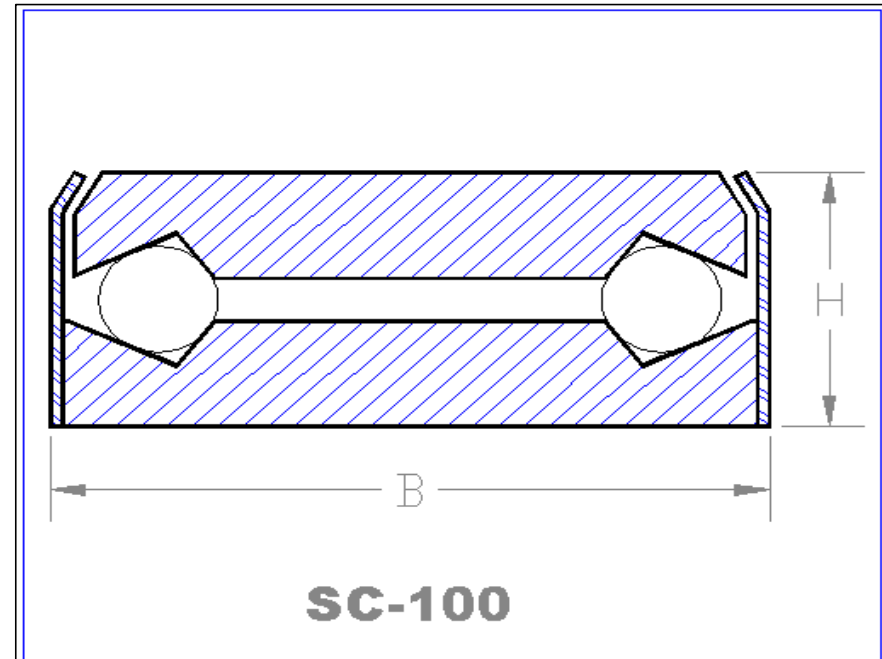

# AUBURN BALL BEARING SC-100

Bearing Number	B Outside Diameter	B Tolerance +.000	H Height	H Tolerance + or -	Balls No. - Size	Bearing Weight in Lbs.	THRUST LOAD CAPACITY IN LBS. AT VARIOUS SPEEDS							
							25 RPM	50 RPM	100 RPM	200 RPM	300 RPM	500 RPM	1000 RPM	1500 RPM
SC-45	4 5/8	-.010	1	.005	27 - 7/16	4.52	9460	7675	6230	5055	4475	3840	3115	2755
SC-46	4 5/8	-.010	1 5/8	.005	16 - 11/16	7.05	16875	13695	11115	9020	7985	6845	5560	4920
SC-47	5	-.010	1	.005	30 - 7/16	4.60	9490	7700	6250	5075	4490	3850	3125	-
SC-48	5	-.010	2 1/4	.005	11 - 1	10.66	24490	19870	16130	13090	11590	9935	8065	-