

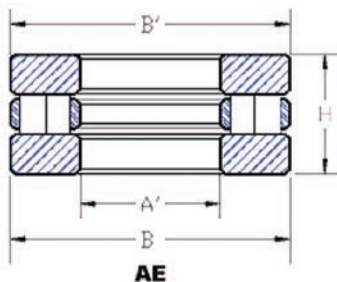

# AE Auburn Open Style AE Roller Thrust Bearing

The AE Series is suitable for applications where space is limited and bearings of heavy load carrying capacity are required. Because they have a larger contact area, the roller series offers increased load capacity and greater shock absorption than ball bearings with similar dimensions. The AE bearing consists of three pieces: a bronze retainer with hardened steel rollers and two hardened steel, ground finished races. The SAE 660 bronze retainer that separates and retains the rollers is well suited for applications where lack of lubrication or contamination prohibit using stamped out or plastic retainers.



## AE Mounting Instructions

The AE bearing series is designed to allow a slip fit of the races and retainer. The inside diameters A and A' and outside diameters B and B', of each of the washers is identical, making them interchangeable. The inside diameter of the retainer and washers is designed to be installed with a slip fit on the shaft. The outside diameters B and B' of the washers

**Please note:** Part numbers with a grey background indicate items normally stocked in Macedon, NY.

### DIMENSIONS IN INCHES

### THRUST LOAD CAPACITY IN POUNDS AT VARIOUS SPEEDS

Bearing Number	DIMENSIONS IN INCHES							THRUST LOAD CAPACITY IN POUNDS AT VARIOUS SPEEDS				
	A Bore (A Tolerance) +.003 +.005	A' Bore (A' Tolerance) +.003 +.005	B Outside Diameter (B Tolerance) +.000 -.003	B' Outside Diameter (B' Tolerance) +.000 -.003	H Height (Height Tolerance) + or -.005	Diameter of Rollers	Bearing Weight in Lbs.	10 RPM	25 RPM	100 RPM	500 RPM	1500 RPM
AE 18	7/8	7/8	1-27/32	1-27/32	5/8	1/4	.25	6674	4882	3090	1823	1436
AE 19	15/16	15/16	1-27/32	1-27/32	5/8	1/4	.25	5940	4345	2750	1622	1279
AE 20	1	1	1-31/32	1-31/32	5/8	1/4	.37	7344	5372	3400	2006	1581
AE 21	1-1/16	1-1/16	1-31/32	1-31/32	5/8	1/4	.37	6534	4779	3025	1785	1407
AE 22	1-1/8	1-1/8	2-3/32	2-3/32	5/8	1/4	.37	8992	5846	3700	2183	1720
AE 23	1-3/16	1-3/16	2-3/32	2-3/32	5/8	1/4	.37	8992	5846	3700	2183	1720
AE 24	1-1/4	1-1/4	2-11/32	2-11/32	5/8	1/4	.50	10584	7742	4900	2891	2279
AE 25	1-5/16	1-5/16	2-11/32	2-11/32	5/8	1/4	.50	9638	7050	4462	2633	2075
AE 26	1-3/8	1-3/8	2-15/32	2-15/32	5/8	1/4	.50	11409	8346	5282	3116	2456
AE 27	1-7/16	1-7/16	2-15/32	2-15/32	5/8	1/4	.56	10368	7584	4800	2832	2232
AE 28	1-1/2	1-1/2	2-19/32	2-19/32	5/8	1/4	.56	10584	7742	4900	2891	2278
AE 29	1-9/16	1-9/16	2-19/32	2-19/32	5/8	1/4	.56	11858	8674	5490	3239	2553
AE 30	1-5/8	1-5/8	2-31/32	2-31/32	13/16	5/16	1.00	15960	11675	7389	4360	3436
AE 31	1-11/16	1-11/16	2-31/32	2-31/32	13/16	5/16	1.00	14742	10784	6825	4026	3175
AE 32	1-3/4	1-3/4	3-3/32	3-3/32	13/16	5/16	1.00	17100	14309	7917	4671	3682
AE 33	1-13/16	1-13/16	3-3/32	3-3/32	13/16	5/16	1.00	15793	11552	7312	4314	3400
AE 34	1-7/8	1-7/8	3-7/32	3-7/32	13/16	5/16	1.00	18241	13343	8445	4982	3926
AE 35	1-15/16	1-15/16	3-7/32	3-7/32	13/16	5/16	1.00	16848	14424	7800	4602	3627
AE 36	2	2	3-11/32	3-11/32	13/16	5/16	1.12	18241	13343	8445	4982	3926
AE 37	2-1/8	2-1/8	3-19/32	3-19/32	13/16	5/16	1.25	23654	17302	10951	6461	5092
AE 37S	2-3/16	2-3/16	3-19/32	3-19/32	13/16	5/16	1.25	19634	14362	9090	5363	4226
AE 38	2-1/4	2-1/4	3-23/32	3-23/32	13/16	5/16	1.50	24967	18263	11559	6817	5384
AE 39	2-3/8	2-3/8	3-27/32	3-27/32	13/16	5/16	1.50	26282	19225	12168	7179	5658
AE 39S	2-7/16	2-7/16	3-27/32	3-27/32	13/16	5/16	1.50	20861	15259	9658	5698	4490
AE 40	2-1/2	2-1/2	3-31/32	3-31/32	13/16	5/16	1.50	33343	24390	15437	9107	7178
AE 41	2-5/8	2-5/8	4-11/32	4-11/32	1	3/8	2.37	38473	28142	17812	10509	8282
AE 42	2-3/4	2-3/4	4-15/32	4-15/32	1	3/8	2.50	36450	26662	16875	9956	7846
AE 43	3	3	4-23/32	4-23/32	1	3/8	2.75	42523	31105	19687	11615	9154
AE 44	3-1/4	3-1/4	4-31/32	4-31/32	1	3/8	3.00	44550	32587	20625	12168	9590
AE 44S	3-7/16	3-7/16	5-7/32	5-7/32	1	3/8	3.00	39463	28866	18270	10779	8495
AE 45	3-1/2	3-1/2	5-7/32	5-7/32	1	3/8	3.00	46573	34067	21562	12722	10026
AE 45S	3-9/16	3-9/16	5-7/32	5-7/32	1	3/8	2.87	37152	27176	17200	10148	7998