

SC-100 Auburn Totally Enclosed Style SC-100 Ball Thrust Bearing



The SC-100 Series is recommended for use in exposed locations where protection from foreign matter is required. The one piece design answers the need for an easily installed bearing that requires a minimum of machine work. The balls are retained between two hardened steel races which are banded together by a mild steel or brass sleeve on the outside diameter. The "V" grooved raceway design creates less friction than a full contact round groove design.

Please note: Part numbers with a grey background indicate items normally stocked in Macedon, NY.

DIMENSIONS IN INCHES							THRUST LOAD CAPACITY IN POUNDS AT VARIOUS SPEEDS							
Bearing Number	B Outside Diameter	B Tolerance + .000	H Height	H Tolerance + or -	Balls No. - Size	Bearing Weight in Lbs.	25 RPM	50 RPM	100 RPM	200 RPM	300 RPM	500 RPM	1000 RPM	15000 RPM
SC-00	$1\frac{1}{16}$	-.002	$\frac{5}{16}$.005	12- $\frac{1}{8}$.06	600	485	395	320	285	245	200	175
SC-0	$\frac{3}{4}$	-.002	$\frac{5}{16}$.005	13- $\frac{1}{8}$.08	630	515	415	340	300	260	210	185
SC- $\frac{3}{8}$	1- $\frac{13}{16}$	-.003	$\frac{1}{2}$.005	12- $\frac{7}{32}$.16	1730	1405	1140	925	820	700	570	505
SC- $\frac{1}{2}$	1- $\frac{3}{16}$	-.003	$\frac{3}{8}$.005	17- $\frac{5}{32}$.12	1155	935	760	615	545	470	380	335
SC-1	1- $\frac{3}{16}$	-.003	$\frac{5}{8}$.005	10- $\frac{1}{4}$.26	1930	1570	1275	1035	915	785	635	565
SC-2	1- $\frac{3}{8}$	-.003	$\frac{5}{8}$.005	12- $\frac{1}{4}$.28	2225	1805	1465	1190	1050	905	735	645
SC-3	1- $\frac{1}{2}$	-.004	$1\frac{1}{16}$.005	14- $\frac{3}{4}$.33	2480	2015	1635	1325	1175	1005	820	725
SC-4	1- $\frac{13}{16}$	-.005	$1\frac{1}{16}$.005	13- $\frac{5}{16}$.58	3570	2895	2350	1905	1690	1450	1175	1040
SC-5	2	-.005	$1\frac{3}{16}$.005	12- $\frac{3}{8}$.73	4700	3815	3095	2510	2225	1905	1550	1370
SC-6	2	-.005	$1\frac{1}{16}$.005	15- $\frac{5}{16}$.60	3940	3195	2595	2105	1865	1600	1300	1150
SC-10	2- $\frac{3}{16}$	-.006	$1\frac{3}{16}$.005	13- $\frac{3}{8}$.85	4985	4045	3285	2665	2360	2025	1645	1455
SC-11	2- $\frac{3}{16}$	-.006	$1\frac{5}{16}$.005	13- $\frac{3}{8}$.95	4985	4045	3285	2665	2360	2025	1645	1455
SC-12	2- $\frac{3}{16}$	-.006	$1\frac{1}{16}$.005	16- $\frac{5}{16}$.66	4100	3325	2700	2190	1940	1665	1350	1195
SC-13	2- $\frac{3}{16}$	-.006	$1\frac{1}{16}$.005	17- $\frac{5}{16}$.68	4250	3450	2800	2275	2010	1725	1400	1240
SC-14	2- $\frac{13}{32}$	-.006	$1\frac{5}{16}$.005	15- $\frac{3}{8}$	1.11	5505	4465	3625	2940	2605	2235	1815	1605
SC-17	2- $\frac{13}{32}$	-.006	$1\frac{1}{16}$.005	18- $\frac{5}{16}$.76	4395	3565	2895	2350	2080	1785	1450	1280
SC-18	2- $\frac{13}{32}$	-.006	$1\frac{1}{16}$.005	19- $\frac{5}{16}$.78	4525	3665	2975	2415	2135	1835	1485	1315
SC-19	2- $\frac{1}{2}$	-.006	$1\frac{5}{16}$.005	16- $\frac{3}{8}$	1.27	5730	4650	3775	3065	2710	2325	1890	1670
SC-20	2- $\frac{19}{32}$	-.007	$1\frac{5}{16}$.005	17- $\frac{3}{8}$	1.35	5945	4825	3915	3180	2815	2410	1960	1735
SC-21	2- $\frac{19}{32}$	-.007	$1\frac{1}{16}$.005	20- $\frac{5}{16}$.67	4630	3750	3050	2475	2190	1875	1525	1350
SC-24	2- $\frac{19}{32}$	-.007	$1\frac{1}{16}$.005	21- $\frac{5}{16}$.69	4750	3855	3130	2540	2250	1930	1565	1385
SC-25	2- $\frac{3}{4}$	-.007	$1\frac{1}{16}$.005	22- $\frac{5}{16}$.99	4820	3910	3175	2575	2280	1955	1590	1405
SC-26	2- $\frac{3}{4}$	-.007	$1\frac{3}{16}$.005	18- $\frac{3}{8}$	1.33	6140	4985	4045	3285	2905	2490	2025	1790
SC-27	2- $\frac{3}{4}$	-.007	$1\frac{3}{16}$.005	23- $\frac{5}{16}$	1.21	4910	3985	3235	2625	2325	1995	1620	1430

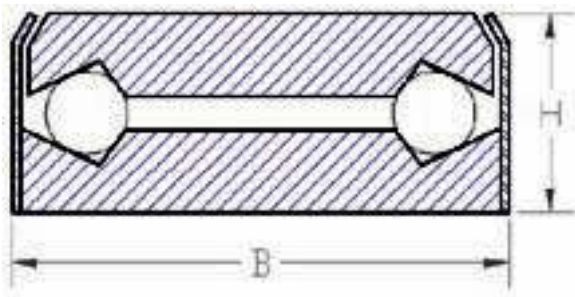

SC-100 Series Mounting Instructions

The SC-100 Series is generally installed so that the race with the sleeve attached to it seats against a fixed part of the machine and is stationary.

DIMENSIONS IN INCHES							THRUST LOAD CAPACITY IN POUNDS AT VARIOUS SPEEDS							
Bearing Number	B Outside Diameter	B Tolerance + .000	H Height	H Tolerance + or -	Balls No. - Size	Bearing Weight in Lbs.	25 RPM	50 RPM	100 RPM	200 RPM	300 RPM	500 RPM	1000 RPM	15000 RPM
SC-28	2- ³ / ₄	-.007	1	.005	15- ⁷ / ₁₆	1.51	7280	5910	4795	3890	3365	2955	2400	2120
SC-29	3	-.008	1- ³ / ₁₆	.005	14- ¹ / ₂	3.34	8830	7165	5815	4720	4180	3580	2910	2575
SC-30	3	-.008	¹³ / ₁₆	.005	20- ³ / ₈	1.42	6485	5260	4270	3465	3070	2630	2135	1890
SC-32	3- ³ / ₁₆	-.008	1- ¹ / ₈	.005	15- ¹ / ₂	2.15	9255	7510	6095	4945	4380	3755	3050	2825
SC-33	3- ³ / ₁₆	-.008	¹³ / ₁₆	.005	26- ⁵ / ₁₆	1.70	5070	4115	3340	2710	2400	2060	1670	1480
SC-35	3- ¹ / ₄	-.008	¹³ / ₁₆	.005	22- ³ / ₈	2.33	6755	5485	4450	3610	3195	2740	2225	1970
SC-36	3- ¹ / ₄	-.008	¹³ / ₁₆	.005	28- ⁵ / ₁₆	2.20	5130	4165	3380	2745	2430	2085	1690	1495
SC-37	3- ¹ / ₄	-.008	1- ³ / ₁₆	.005	16- ¹ / ₂	2.58	9640	7825	6350	5155	4560	3910	3175	2810
SC-39	3- ⁷ / ₈	-.010	1- ¹ / ₄	.005	19- ¹ / ₂	3.67	10635	8630	7005	5685	5030	4315	3505	3100
SC-41	4	-.010	1- ¹ / ₄	.005	20- ¹ / ₂	3.79	10900	8845	7180	5830	5160	4425	3590	3175
SC-41A	4	-.010	1- ⁵ / ₈	.005	13- ¹¹ / ₁₆	5.00	14690	11920	9675	7855	6950	5960	4840	4280
SC-43	4- ⁵ / ₈	-.010	1- ¹ / ₂	.005	19- ⁵ / ₈	5.95	15780	12805	10395	8435	7470	6405	5200	4600
SC-45	4- ⁵ / ₈	-.010	1	.005	27- ⁷ / ₁₆	4.52	9460	7675	6230	5055	4475	3840	3115	2755
SC-46	4- ⁵ / ₈	-.010	1- ⁵ / ₈	.005	16- ¹¹ / ₁₆	7.05	16875	13695	11115	9020	7985	6845	5560	4920
SC-47	5	-.010	1	.005	30- ⁷ / ₁₆	4.60	9490	7700	6250	5075	4490	3850	3125	-
SC-48	5	-.010	2- ¹ / ₄	.005	11 - 1	10.66	24490	19870	16130	13090	11590	9935	8065	-